

393: Signal specification, infotainment control module (ICM)

XC90, 2006, B5254T2, L.H.D

15/3/2023

**PRINT****393: Signal specification, infotainment control module (ICM)****Signal specification****General**

All values given below are between the terminals stated in column 1 and terminal #A10 in column 2 (signal ground). This applies unless otherwise indicated in brackets.

Note! It is important to connect the breakout box and check the ground terminals before taking readings.

U = DC voltage in volts (V)
 U_{bat} = Battery voltage (V)

U_{low} = Voltage approximately 0 V

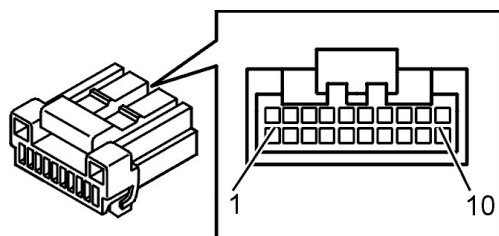
**Connector A**

Terminal	Breakout box terminal	Signal type	Ignition on	Ignition off	Other
#A1	#A1	30 supply	U = U _{bat}	U = U _{low}	
#A2	#A2	Reserve	-	-	
#A3	#A3	Communication CAN L low speed network	During communication the voltage is 1.5-2.5 V		
#A4	#A4	Communication CAN L low speed network	During communication the voltage is 1.5-2.5 V		
#A5	#A5		During communication the voltage is 2.0-3.5 V		

		Communication CAN_H low speed network			
#A6	#A6	Communication CAN_H low speed network	During communication the voltage is 2.0-3.5 V		
#A7	#A7	Reserve	-	-	
#A8	#A8	Reserve	-	-	
#A9	#A9	Reserve	-	-	
#A10	#A10	Power ground	U = Ulow	U = Ulow	

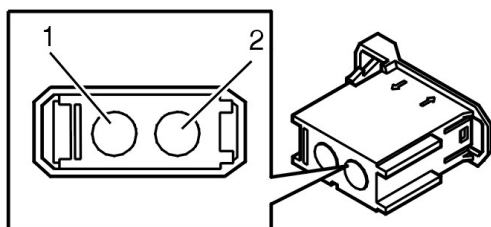
**Connector C**

Terminal	Breakout box terminal	Signal type	Ignition on	Other
#C1		MOST input signal	-	Optical input signal
#C2		MOST output signal	-	Optical output signal

15/3/2023

PRINT